

MISSOULA HISTORIC RESIDENTIAL STYLES

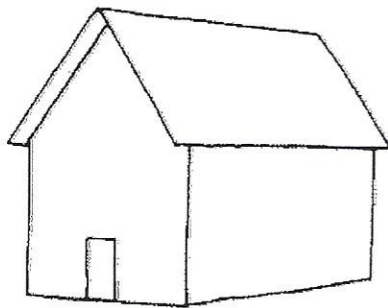

Gabled Roof

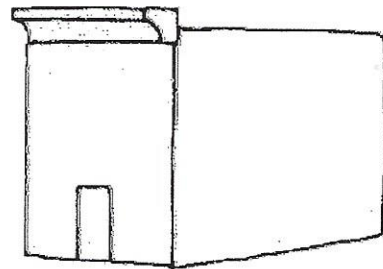

Low Slope Roof with Cornice

Victorian Stick Style

All images on this page © 1984
Virginia Savage and Lee McAlester,
A Field Guide to American Houses,
Alfred A. Knopf, Inc.

MISSOULA HISTORIC RESIDENTIAL STYLES

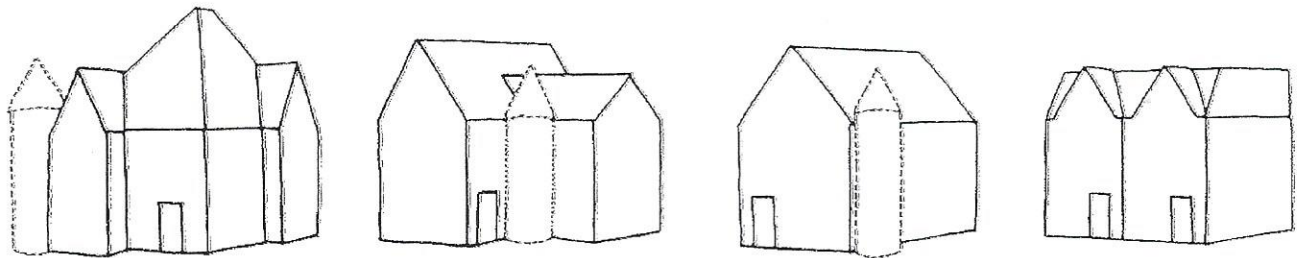

Shape Subtypes

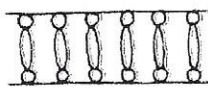

SPINDLEWORK

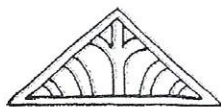

HALF-TIMBERED

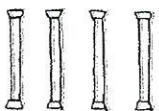

FREE CLASSIC

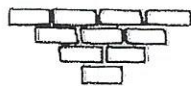

PATTERNED MASONRY

American Queen Anne Style

All images on this page © 1984
Virginia Savage and Lee McAlester,
A Field Guide to American Houses,
Alfred A. Knopf, Inc.

MISSOULA HISTORIC RESIDENTIAL STYLES



HEPPED ROOF WITH CROSS GABLES

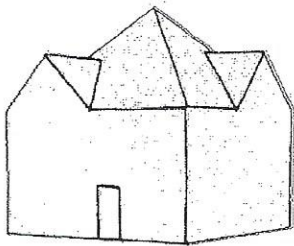

SIDE-GABLED ROOF

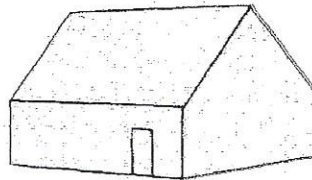

FRONT-GABLED ROOF

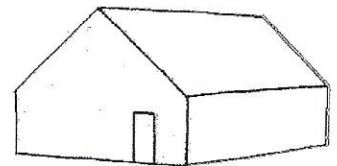

CROSS-GABLED ROOF

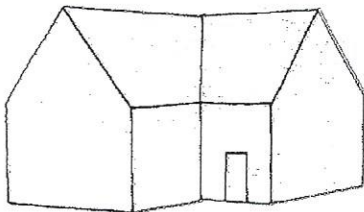

GAMBREL ROOF

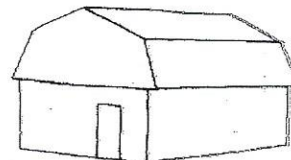

Shingle Style

All images on this page © 1984
Virginia Savage and Lee McAlester,
A Field Guide to American Houses,
Alfred A. Knopf, Inc.

MISSOULA HISTORIC RESIDENTIAL STYLES



FRONT-GABLED ROOF

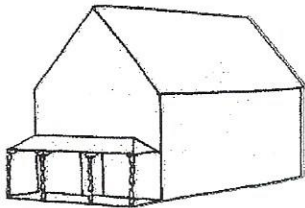

GABLE FRONT AND WING

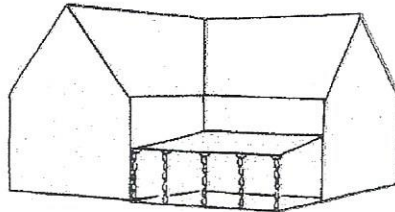

SIDE-GABLED ROOF, ONE-STORY

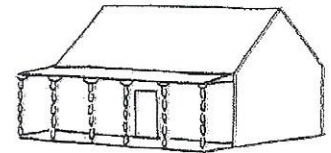

SIDE-GABLED ROOF, TWO-STORY

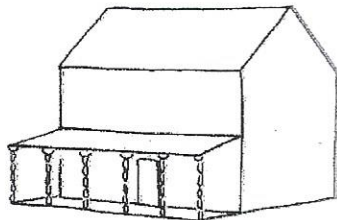

PYRAMIDAL

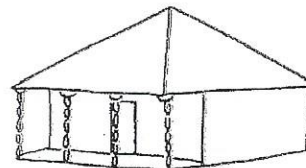

Folk Style

All images on this page © 1984
Virginia Savage and Lee McAlester,
A Field Guide to American Houses,
Alfred A. Knopf, Inc.

MISSOULA HISTORIC RESIDENTIAL STYLES



HIPPED ROOF, SYMMETRICAL,
WITH FRONT ENTRY

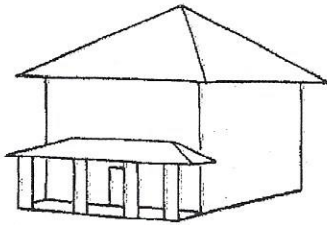

HIPPED ROOF, SYMMETRICAL,
NO FRONT ENTRY

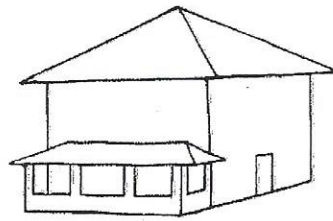

HIPPED ROOF,
ASYMMETRICAL

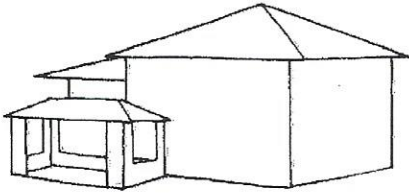

GABLED ROOF

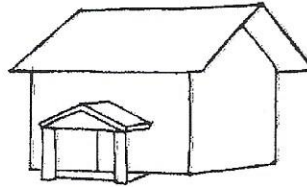

Prairie Style

All images on this page © 1984
Virginia Savage and Lee McAlester,
A Field Guide to American Houses,
Alfred A. Knopf, Inc.

MISSOULA HISTORIC RESIDENTIAL STYLES



FRONT-GABLED ROOF

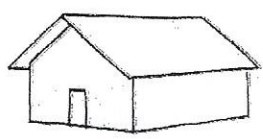

CROSS-GABLED ROOF

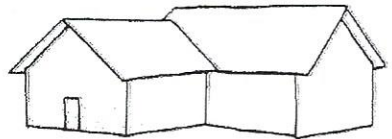

SIDE-GABLED ROOF

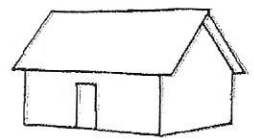

HIPPED ROOF



Arts and Crafts or Bungalow Style

All images on this page © 1984
 Virginia Savage and Lee McAlester,
A Field Guide to American Houses,
 Alfred A. Knopf, Inc.

MISSOULA HISTORIC RESIDENTIAL STYLES

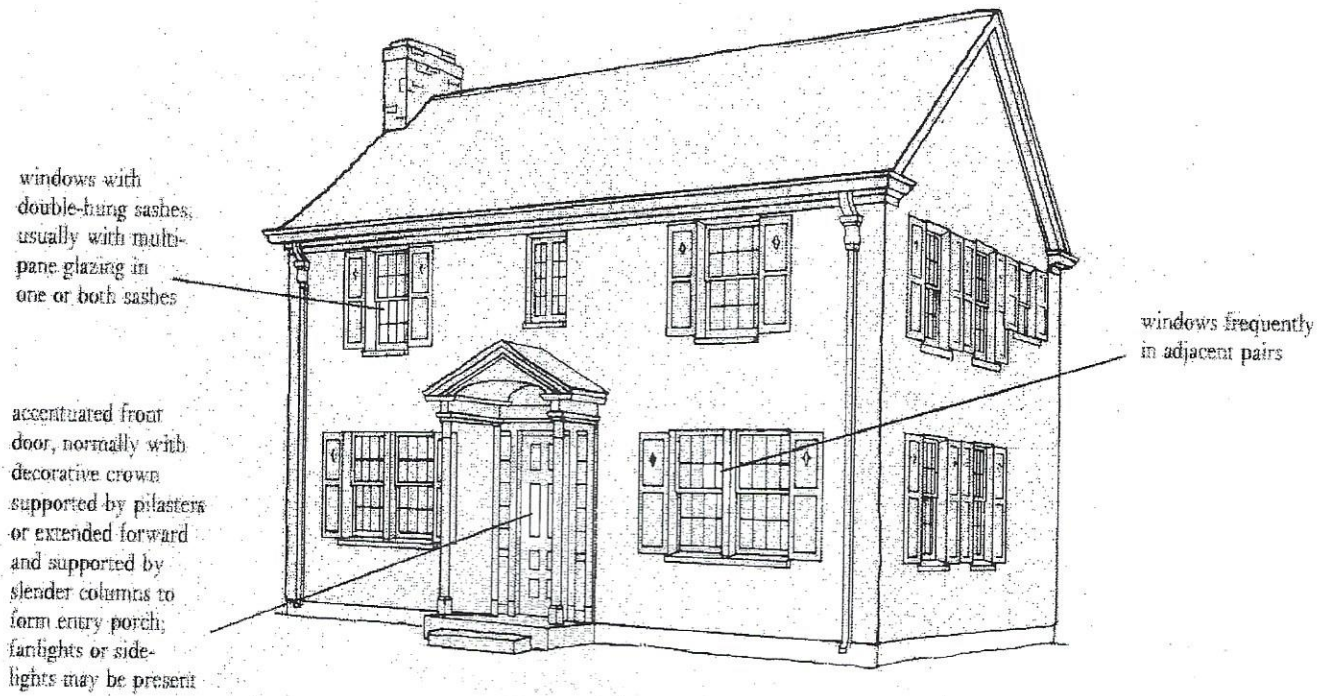

ASYMMETRICAL

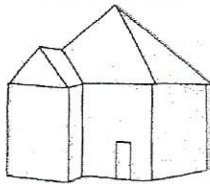

HIPPED ROOF WITH FULL-WIDTH PORCH



HIPPED ROOF WITHOUT FULL-WIDTH PORCH

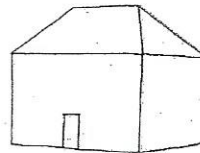

SIDE-GABLED ROOF

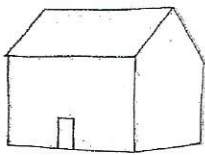

CENTERED GABLE

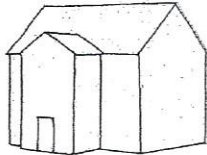

GAMBREL ROOF

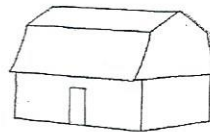

SECOND-STORY OVERHANG

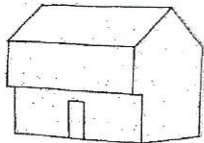

ONE-STORY

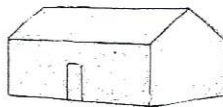

THREE-STORY

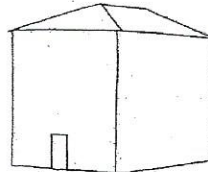

Colonial Revival

All images on this page © 1984
Virginia Savage and Lee McAlester,
A Field Guide to American Houses,
Alfred A. Knopf, Inc.